

Main
Street
East

OFFICE FOR LEASE

229-259 E. Michigan Ave. | Suite 107 | Kalamazoo, MI 49007

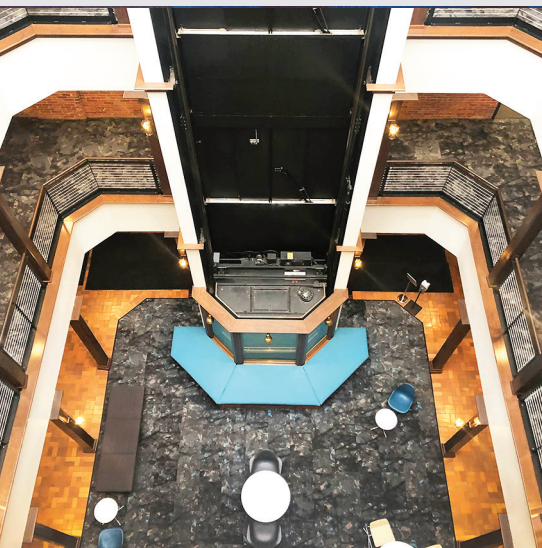
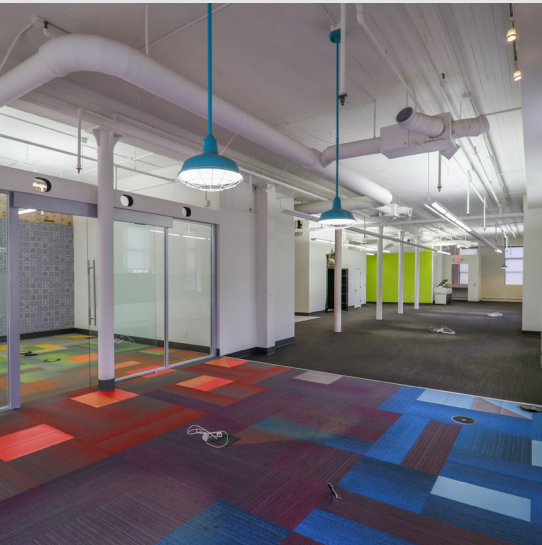

Property Details

Historic multi-client building offering flexible and innovative high-end suites consisting of 500 SF up to 8,000 SF.

The building features turn-of-the-century charm with exposed brick and natural wood, along with an abundance of natural light including a 4-story open atrium ideal for future networking events.

Suites comprise of different layouts ranging from hard offices to open concepts with vaulted ceilings as well as great views of downtown Kalamazoo.

Amenities

- Dedicated parking
- Accessible on-site management
- Steps away from banking, restaurants, shopping, parks, and more
- Conveniently located in downtown Kalamazoo within the heart of the business and entertainment district

Major Clients

- LKF Marketing
- Barbara Foley: Chapter 13 Trustee
- Clear Ridge Wealth Management, LLC
- TMP Architecture
- Steelhead Engineering/Seven Generations AE
- KCRReady4s



TREYSTAR™
Locate. Partner. Grow.

Fritz Brown
Office Leasing
269.217.5179 | fbrown@treystar.com



Suite Description

- This space is 3,033 square feet
- Ground-level space with fantastic visibility
- Historic details within the space
- Modern amenities compliment throughout
- Dedicated kitchen within the space
- Access through atrium & directly outdoors

